

LED Panel Lamps Manual



Usage

The lamp is used for the illumination of stationary control cabinets and electrical enclosures.

Safety Guidelines

- Installation must only be carried out by qualified electrical technicians in observation of the respective national power supply guidelines (IEC 60364)
- The safety measures according to VDE 0100 have to be ensured
- Lamps with magnetic fixing need to be checked to ensure that the holding power of the magnets is sufficient for the respective application including the connection cable
- The lamps must be mounted stationary
- With magnet fixing the lamp can be flexibly mounted inside the electrical cabinet/enclosure
- The technical specifications on the type plate must be strictly observed
- The device must not be opened for repair
- The lamp must not be used as a hand light

Spring loaded connection:

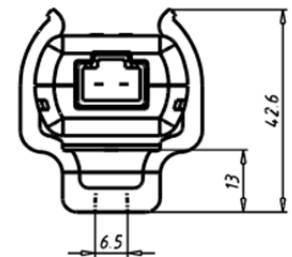
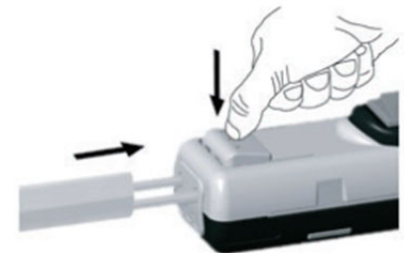

Warning

There is a risk of personal injury and equipment damage if the connection values are not observed or polarity is incorrect.

